



Item Description Pump, infusion	Equipment Number 13-215
---	-----------------------------------

Potential Manufacturer ----- Baxter ----- CareFusion [CardinalHealth] -----	Model Number ----- Colleague ----- Alaris -----
--	--

Further Description:

- Fluid infusion pump for patient treatment which consist of independent channels and a main unit

Specifications:

Dimensions and weight:

Alaris: (1x main 8015 + 4x modules 8100)
W x D x H: 580 x 230 x 230 mm
Weight: 12 Kg
Each module is W x D x H: 80 x 160 x 210 mm

IV pole stand: 640 x 640 x 1800 mm
Weight: 25 Kg

Electrical Requirements:

120V, 50/60 Hz, 150VA

Data Requirements:

Wireless network availability

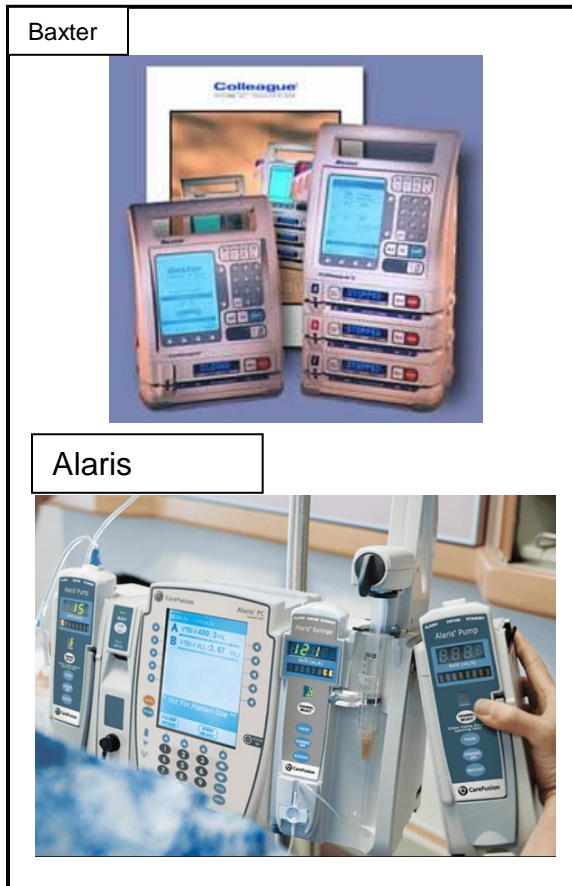

Design and Installation Notes:

This information is provided for planning purposes only and is not to be relied upon. Final installation specifications are dependent upon selected supplier's shop drawings.



Equipment Datasheet

Item Description:
Pump, Infusion, Syringe

Equipment Number:
13-217

Potential Manufacturer	Model Number
BBraun	Perfusor
Smiths-Medical	Medfusion
-----	-----

Further Description:

- A programmable syringe pump used to deliver medication to patients in healthcare environment



Specifications:

Dimensions and weight:
W x D x H: 270 x 160 x 130 mm
Weight: 5 kg

Electrical Requirements:
120 V AC, 60 Hz

Design and Installation Notes:

This information is provided for planning purposes only and is not to be relied upon. Final installation specifications are dependent upon selected supplier's shop drawings.



Equipment Datasheet

Item Description:
Radiographic Unit, Portable

Equipment Number:
13-272

Potential Manufacturer ----- GE ----- Philips -----	Model Number ----- Optima ----- Mobile diagnostic -----
--	--

Further Description:

- Battery driven portable x-ray system with flat panel detector with optional built in acquisition workstation with touch screen monitor
- DICOM and IHE compliant

Specifications:

Dimensions and weight:

W x D x H: 670 x 1380 x 1980 mm

Weight: 460 Kg

Electrical Requirements:

120 V AC, 60 Hz, 15 Amps

Data Requirements:

1 Data port
Wireless connectivity



Design and Installation Notes:

This information is provided for planning purposes only and is not to be relied upon. Final installation specifications are dependent upon selected supplier's shop drawings.



Item Description
Regulator, Suction

Equipment Number
13-325

Potential Manufacturer	Model Number
Boehringer	Platinum Series
	Pediatric

Further Description:

- Suction regulator with adjustable flow rate



Specifications:

Dimensions and weight:
W x H: 120 x 160 mm
Weight: 1 kg

Plumbing Requirements:
Connected to the room suction outlet

Design and Installation Notes:

This information is provided for planning purposes only and is not to be relied upon. Final installation specifications are dependent upon selected supplier's shop drawings.



Item Description:
Resuscitators, CPR , Automated

Equipment Number:
13-363

Potential Manufacturer

Zoll

Stryker

Model Number

Auto Pulse

lucas 3

Further Description:

- A resuscitator used for performing an automated CPR on the patient with adjustable heart rate compressions per minute – fixed or variable during operation , adjustable depthminutes

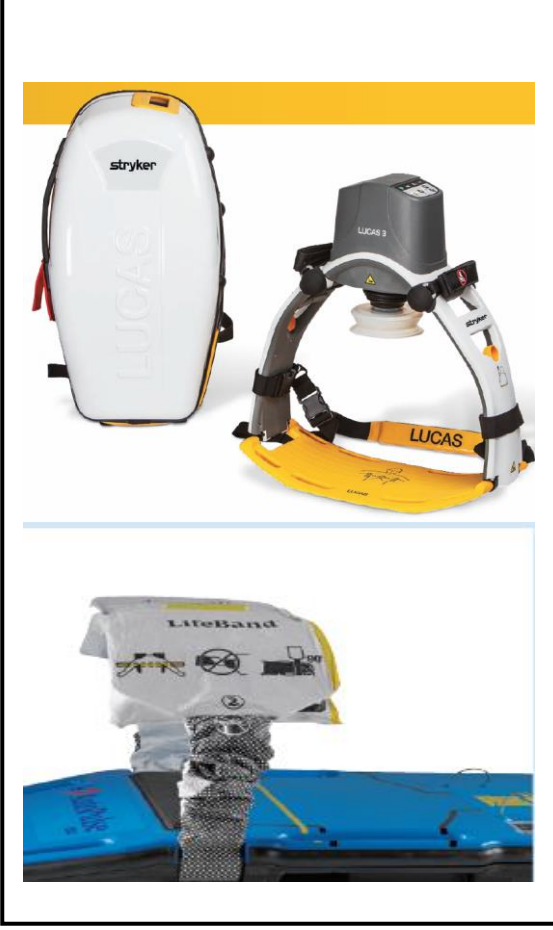

Specifications:

Dimensions and weight:
W x D x H: 520 x 260 x 580 mm

Weight: 5 kg

Electrical Requirements:
Charging: 120VAC, 60Hz

Design and Installation Notes:

This information is provided for planning purposes only and is not to be relied upon. Final installation specifications are dependent upon selected supplier's shop drawings.

Item Description
Resuscitators, Pulmonary, Pneumatic

Equipment Number
13-366

Potential Manufacturer	Model Number
-----	-----
Fisher & Paykel	Neopuff
-----	-----

Further Description:

- Resuscitator with O2 21-100 % range delivery, can be portable, pole, or infant warmer mounted



Specifications:

Dimensions and weight:
W x D x H: 210 x 110 x 260 mm
Weight: 3 kg

Plumbing Requirements:
Oxygen required

Design and Installation Notes:

This information is provided for planning purposes only and is not to be relied upon. Final installation specifications are dependent upon selected supplier's shop drawings.



Equipment Datasheet

Item Description
Exercisers, Aerobic, Rowing

Equipment Number
13-426

Manufacturer ----- Avari ----- -----	Model Number ----- Programmable Magnetic Rower ----- -----
---	---

Further Description:

- Eddy Current drive belt system
- Self-powered system
- Magnetic resistance system
- 12 levels of resistance
- 4 kg (8.8 lb.) Flywheel
- Single handle rowing style
- LCD console displays time, count, distance, calories, strokes per minute, pulse and watt
- Pulse sensor with integrated Polar compatible receiver for use with chest strap (chest strap included)
- Pivoting foot plates with adjustable foot straps
- Folds for easy storage
- Built-in transportation wheels
- Need assembly
- Maximum user weight: 129.3 kg (285 lb.)
- 1 Year Warranty



Specifications:

- Set up dimensions (L x W x H):
206 cm x 51 cm x 62 cm (80 in. x 20 in. x 24.5 in.)
- Folded dimensions (L x W x H):
136.5 cm x 45 cm x 158.7 cm (53.8 in. x 17.8 in. x 62.5 in.)
- Weight: 40 kg (88 lb.)

Installation Consideration:

- May need power plug
- Provide enough space around for work flow

This information is provided for planning purposes only and is not to be relied upon. Final installation specifications are dependent upon selected supplier's shop drawings.



fraserhealth

Better health.
Best in health care.

Equipment Datasheet

Item Description:
Scale

Equipment Number:
13-455

Potential Manufacturer ----- Health o Meter ----- Global industrial	Model Number ----- Digital Waist-Level Physician Scales ----- Physician scale
---	---

Further Description:

- Scale with optional height rod with anti-slip platform



Specifications:

Dimensions and weight:

W x D x H: 390 x 560 x 1490 mm
Weight: 20 kg

Electrical Requirements:

120 V AC, 50/60 Hz

Design and Installation Notes:

This information is provided for planning purposes only and is not to be relied upon. Final installation specifications are dependent upon selected supplier's shop drawings.



Item Description
Stretcher, Motorized/Bariatric

Equipment Number
13-816

Potential Manufacturer	Model Number
-----	-----
Amico	-----
-----	-----
Meditek	-----
-----	-----

Further Description:

- Bariatric patient weight rated stretcher with motorized range of motion and option IV poles



Specifications:

Dimensions and weight:

W x D x H: 1000 x 2140 x 840 mm

Weight: 210 kg

Power Requirement:

120V AC, 60 Hz

Design and Installation Notes:

This information is provided for planning purposes only and is not to be relied upon. Final installation specifications are dependent upon selected supplier's shop drawings.



fraserhealth

Better health.
Best in health care.

Equipment Datasheet

Item Description
Stretcher, Standard

Equipment Number
13-820

Manufacturer	Model Number
-----	-----
Stryker	Prime Series
-----	-----
Hill-Rom	-----
-----	-----

Further Description:

- Standard stretcher used for patient transport with IV pole mounting option



Specifications:

Dimensions:
W x L x H: 970 x 2190 x (520-870) mm

Electrical Requirements:
120 V AC, 60 Hz

Design and Installation Notes:

This information is provided for planning purposes only and is not to be relied upon. Final installation specifications are dependent upon selected supplier's shop drawings.



Equipment Datasheet

Item Description:
Tables, Instrument, Mayo

Equipment Number
13-959

Manufacturer ----- Stevens ----- -----	Model Number ----- 145-P-1065-SS ----- -----
---	---

- Specifications:
- All welded stainless steel construction
 - Removable, 20" x 25" stainless steel tray
 - Foot-pedal operated friction lock adjusts height from 36" to 62"
 - Base designed to move under low clearance equipment



This information is provided for planning purposes only and is not to be relied upon. Final installation specifications are dependent upon selected supplier's shop drawings.



Item Description
Tables, Instrument

Equipment Number
13-959

Potential Manufacturer ----- Surgical Imperial ----- Stevens -----	Model Number ----- ----- -----
---	---

Further Description:

- Welded stainless steel cart used in surgical facilities and healthcare offices to store and transport delicate instruments available in different sizes

Specifications:

Dimensions and weight:

Large: W x D x H: 1530 x 610 x 1200 mm

Small x D x H: 870 x 470 x 1200 mm

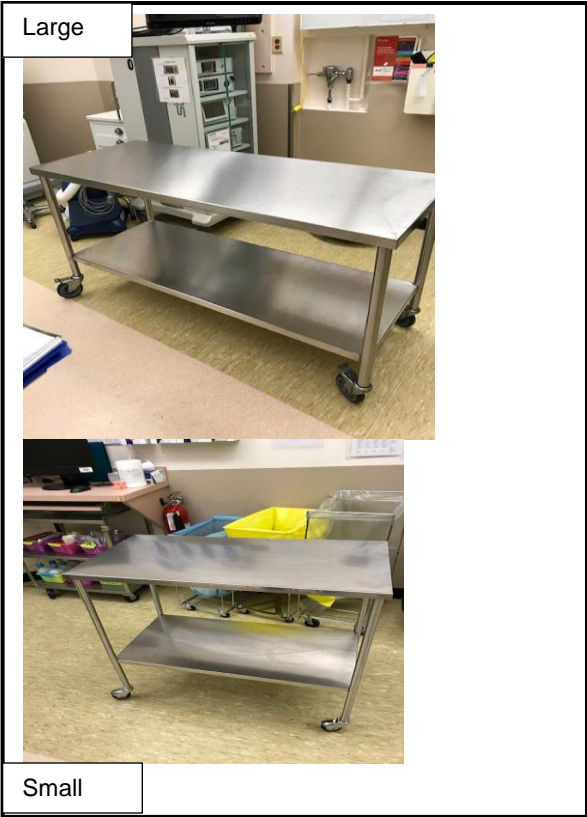

Design and Installation Notes:

This information is provided for planning purposes only and is not to be relied upon. Final installation specifications are dependent upon selected supplier's shop drawings.



Item Description:
Table, Operating

Equipment Number
13-961

Potential Manufacturer ----- Steris ----- Hill-Rom ----- Stryker	Model Number ----- ----- -----
--	---

Further Description:

- Surgical suite compatible table that can support the patient weight during surgery with wide range of movements and additional options depending on the clinical needs



Specifications:

Dimensions and weight:

W x D x H: 620x 2260 x 1215 mm

Table Weight: 340 Kg

Electrical Requirements:

120 V AC, 60 Hz

Design and Installation Notes:

This information is provided for planning purposes only and is not to be relied upon. Final installation specifications are dependent upon selected supplier's shop drawings.



Item Description:
Table, Operating, Accessories

Equipment Number
13-961.1

Potential Manufacturer	Model Number
----- Steris	-----
----- Hill-Rom	-----
-----	-----

Further Description:

- This cart stores the additional accessories that is used for operating room procedures



Specifications:

Dimensions and weight:

Accessories Cart: W x D x H: 1600 x 700 x 1400 mm

Design and Installation Notes:

This information is provided for planning purposes only and is not to be relied upon. Final installation specifications are dependent upon selected supplier's shop drawings.

Item Description
Furniture, Table, Overbed

Equipment Number
13-963

Manufacturer ----- Stryker ----- Nurture ----- Clafin Contract Furnishing	Model Number ----- 630-F ----- Opus ----- 4528 Automatic Height
---	---



This information is provided for planning purposes only and is not to be relied upon. Final installation specifications are dependent upon selected supplier's shop drawings.



Item Description: Table, Plinth, Exam	Equipment Number: 13-964
---	------------------------------------

Potential Manufacturer ----- Clinical Supplies ----- Orthocanada -----	Model Number ----- Cardon Physical Therapy Table ----- Seers mobilization table -----
---	--

Further Description:

strong and rigid frame and incorporates an adjustable angle backrest and a one-hand adjustable head section suitable for a wide range of manual therapy techniques and various patient examination procedures

Specifications:

Dimensions:
W x D x H: 1070 x 2040 x 970 mm

Electrical Requirements:
120 V AC, 60 Hz



Design and Installation Notes:

- floor mounted power outlet is required

This information is provided for planning purposes only and is not to be relied upon. Final installation specifications are dependent upon selected supplier's shop drawings.



Equipment Datasheet

Item Description:
Table, Urology System

Equipment Number
13-969

Manufacturer ----- Biodex ----- -----	Model Number ----- 840 / 870 / 800 ----- -----
--	---

Specifications:



This information is provided for planning purposes only and is not to be relied upon.
Final installation specifications are dependent upon selected supplier's shop drawings.

UROLOGY C-ARM TABLE & BRACHYTHERAPY C-ARM TABLE

OPERATION MANUAL

058-800
058-805
058-810
058-815

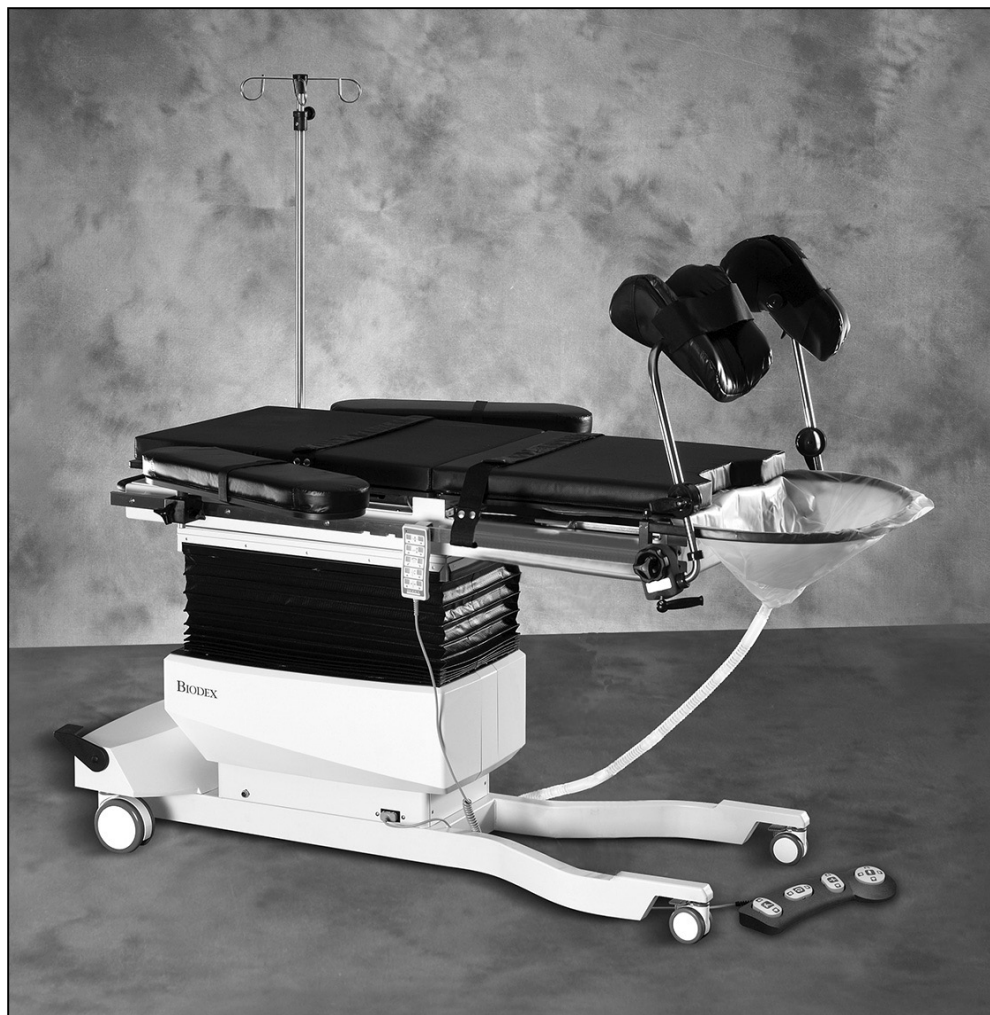

BIODEX

Biodex Medical Systems, Inc.

20 Ramsey Road, Shirley, New York, 11967-4704, Tel: 800-224-6339 (Int'l 631-924-9000), Fax: 631-924-9241, Email: info@biodex.com, www.biodex.com

3. Specifications

058-800 Table, Urology C-Arm, 120 VAC

058-805 Table, Urology C-Arm, 230 VAC

058-810 Table, Brachytherapy, 115 VAC

058-815 Table, Brachytherapy, 230 VAC

Dimensions: 84.5" l x 25.5" w (214.6 x 64.8 cm) with OR accessory rails

Tabletop: 53" l x 21" w (134.6 x 53.3 cm); 84" l (213.4 cm) with extension

Lightweight Extension (for patient transfer only, not for imaging): 26.5" l x 21" w (67.3 x 53.3 cm)

Radiolucent Extension: 31" l x 25.5" w (78.7 x 64.8 cm) with OR accessory rails

Radiolucent Area: 54" l x 17.5" w (137.2 x 44.5 cm)

Tabletop Material: Three Fiberesin™ sections - each with individual 2" mattress

Table Sections: Four Sections: Adjustable Fowler Back 0° to 80°, abdominal section with cutout, radiolucent removable extension and a lightweight non-imaging transfer extension for transferring patients on and off the table

Mattress: Individual seamless, 2" thick (5 cm), one for each section

Motions:

Height: Adjustable from 34" to 43.5" (86.4 to 110.5 cm)

Tabletop X Motion (head-to-toe): 20" (51 cm)

Tabletop Y Motion (side-to-side): 10" (25.4 cm)

Trendelenburg: 0° to 20°

Reverse Trendelenburg: 0° to 20° Lateral Roll: 0° to 20°

Fowler Back: Adjusts from 0° to 80° with touch handle lock/unlock

Controls:

Hand Control: activates all motions

Foot Control: activates all motions

Optional:

X-Ray Film Tray: Removable film cassette tray for 14" x 17" film with cassette mask for 10" x 12" film. Film cassette tray can be removed from either side of the table.

X-Ray Grid: Removable X-Ray grid, 103 line, 8:1 ratio

Wheels:

Foot End - 3" (7.62 cm) individual locking swivel casters

Head End - 5" (12.7 cm) swivel casters with central locking

Accessory Rails: Standard OR accessory rails 1.125" x .375" (2.86 x .95 cm) on table (rails also on table imaging extension)

Patient Restraints: Two body straps, two ankle straps

Finish: Powder coat

Patient Capacity:

- In urologic position: 500 lb (227 kg)

- In use with radiolucent extension: 400 lb (181.4)

- Weight tested to four times the patient load rating.

Power: 115 VAC or 230 VAC and Battery. Battery automatically charges when table is plugged in. An additional battery can be charged with optional wall-mounted charger.

Standard Accessories:

- radiolucent extension
- transfer extension
- bellows skirt (disposable, 250/roll) and dispenser

Warranty: Two years parts and labor

Certifications: ETL and cETL listed to UL-60601-1[®], CAN/CSA© C22.2 No.: 601.1.M90, EN 60601-1, IEC 60601-1-2:2001-09

Optional:

- 056-851 Drain Bag Frame
- 058-860 Drain Pain, Stainless Steel
- 056-853 Crutch, Knee, Simplicity, (pair)
- 058-862 Stirrups, PAL with boot pad (pair)
- 058-865 Arm Board, Standard (pair)
- 058-863 Arm Board, Dura Board with pad (pair)
- 056-850 IV Pole, rail mounted
- 056-862 Battery and Wall Charging Unit, 115 VAC
- 056-863 Battery and Wall Charging Unit, 230 VAC
- 056-463 Grid, X-ray, 103-line 8:1 ratio, 18" x 18"
- 058-866 Cassette Tray Holder, 11" x 14"
- 058-867 Extension Arm Controller

Replacement:

- 056-857 Drain Bags, Sterile, Disposable, 10/pkg *Fits 056-851 Drain Bag Frame*
- 056-460 Hose, Drain, Urology, 40/cs
- 056-802 Bellows Skirt, disposable plastic, 250/roll
Fits Surgical C-Arm Tables 840, Urology C-Arm Table and Brachytherapy Table



Item Description
Telemetry System

Equipment Number
13-987

Manufacturer ----- Philips ----- GE -----	Model ----- IntelliVue Telemetry System ----- Apex Pro -----
--	---



GE

Further description:

- System consists of Transmitter, Receiver, and Antenna
- Interfaces with CIC pro clinical info center
- 72 hours of full disclosure data
- Up to 9 waveforms displayed on monitor
- SpO₂ and NIBP capability
- Electrocardiograph (ECG)
- Multichannel: 5 or 6 lead configuration
- Single channel: 3 lead configuration
- Heart rate detection: 3-300 beats/min
- Device to operate in the medical device frequency range

Specifications:

- Telemetry Transmitter
 - Battery: 1.5 V AA Alkaline, 40 hours life
 - Dimensions: 13.7 (H) x 7.4 (W) x 2.3 (D) cm
 - Weight: 141.8 g
- Telemetry Receiver
 - Capacity: 4 to 16 receivers
 - Network: 802.3 compatible via 10BaseT
 - Line Voltage: 85 to 264 VAC, 47 to 63 Hz
 - Power consumption: 25 Watts max with 4 quad receivers
 - Dimensions: 170 (H) x 325 (W) x 250 (D) mm
 - Weight: 6.4 kg
- Telemetry Antenna System
 - Line Voltage: 85 to 264 VAC, 47 to 63 Hz
 - Power consumption: 25 Watts max with 4 quad receivers



Philips

- Operates in 2.4 GHz ISM band with up to 6 RF channels (TRx4851A transceiver)
- Also can operate in the WMTS band (TRx4841A transceiver)
- ECG only or ECG/SpO₂ transceivers
- System comprised of following units
 - Transceivers
 - Patient leads and sensors
 - IntelliVue access points
 - Access point controller
 - Sync unit
 - Power over Ethernet unit
 - UPS
 - Routers and Switches
- Smart hopping technology looks for strongest signal
- Capacity to support up to 1000 transceivers or wireless bedside monitors
- Two-way communication between transceiver and IntelliVue Information Center
- 2 V-leads with 6-wire ECG
- Transceiver
 - Battery: 2 AA Alkaline
 - Battery Life: 50 hrs (ECG)
 - Battery Life: 18 Hrs. (ECG/SpO₂)
 - Dimensions: 140 (H) x 88 (W) x 37 (D) mm (ECG/SpO₂)
 - Weight: Approx. 324 g
- IntelliVue Information Center
 - Monitoring of wired, wireless, and telemetry beds
 - Access to PACS and LIS
 - Screen displays up to 16 patients
 - Touch screen operation

Supporting Documents:

Installation Considerations:

- Network cabling requirements between this system and comm. closet should be considered.

This information is provided for planning purposes only and is not to be relied upon. Final installation specifications are dependent upon selected supplier's shop drawings.



Equipment Datasheet

Item Description Patient Monitoring, Telemetry, Transmitter	Equipment Number 13-987.1
---	-------------------------------------

Potential Manufacturer ----- Philips ----- GE -----	Model ----- MX ----- Apex Pro -----
--	--

Further Description:

- A battery powered telemetry transmitter that collects patient vitals and transmit them to a central monitor wirelessly

Specifications:

Dimensions and weight:
W x D x H: 80 x 35 x 140 mm
Weight: 1 Kg

Data Requirements:
Availability of dedicated wireless network is required

Philips MX40



GE Apex Pro



Design and Installation Notes:

This information is provided for planning purposes only and is not to be relied upon. Final installation specifications are dependent upon selected supplier's shop drawings.



Item Description
Telemetry, Antenna Solution

Equipment Number
13-987.2

Potential Manufacturer ----- Philips ----- GE -----	Model Number ----- ----- -----
--	---

Further Description:

- An antenna for receiving the signal from the transmitter and delivering it to the central station
- Sometimes is installed on a metal ceiling tile sized suspension enclosure with a lock for accessibility to reduce infection risks



Specifications:

Dimensions and weight:

Antenna: W x D x H: 210 x 250 x 50 mm
Ceiling mount enclosure: 600 x 600 mm
Weight: 6.4 K g

Electrical Requirements:

120 VAC, 60 Hz

Data Requirements:

2 Data ports

Design and Installation Notes:

- Quantity and location of the access points will be provided as per vendor design and coordination with IM/IT
- Adequate power and data plugs are required at the location of installation for the antenna
- Might require Coax cable pending the vendor selected.
- UPS power is required

This information is provided for planning purposes only and is not to be relied upon. Final installation specifications are dependent upon selected supplier's shop drawings.



Equipment Datasheet

Item Description Charger, Telemetry Transmitter	Equipment Number 13-987.3
---	-------------------------------------

Potential Manufacturer ----- Philips ----- GE -----	Model Number ----- IntelliVue CL Charging Station ----- -----
--	--

Further Description:

- Charging Station is intended for recharging and performing battery maintenance procedures for the telemetry receiver

Specifications:

Dimensions and weight:

W x D x H: 350 x 180 x 120 mm

Weight: 3 Kg

Electrical Requirements:

120 V AC, 60 Hz, 2 A

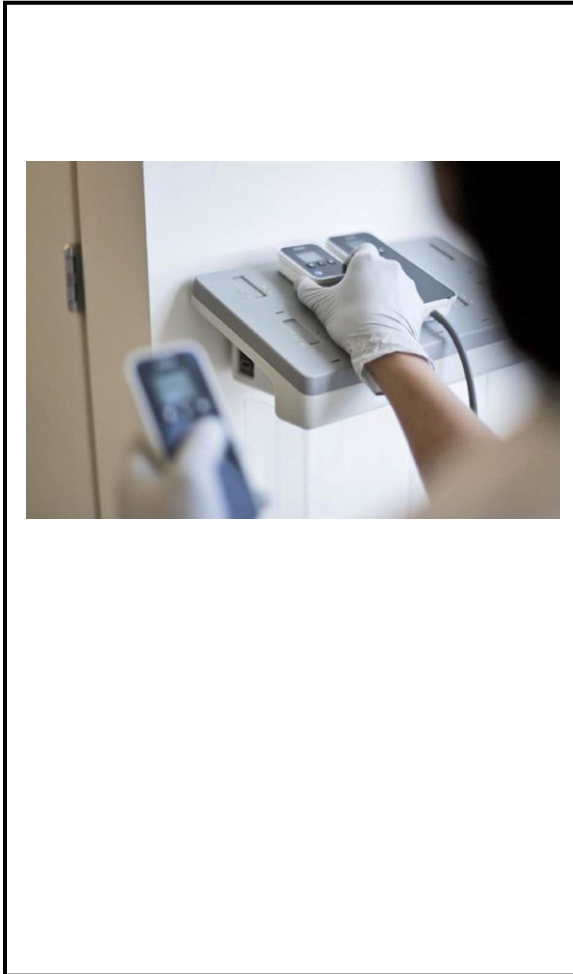

Design and Installation Notes:

- Wall backing is required

This information is provided for planning purposes only and is not to be relied upon. Final installation specifications are dependent upon selected supplier's shop drawings.



Item Description
Thermometer

Equipment Number
14-035

Potential Manufacturer	Model Number
----- Welch Allyn ----- -----	----- Sure Temp Plus ----- -----

Further Description:

- Patient care thermometer with Interchangeable, removable probe, with mechanical or electronic security options to help prevent theft



Specifications:

Dimensions:

Portable: W x D x H: 90 x 220 x 70 mm
Wall mounted W x D x H: 250 x 250 x 100 mm

Design and Installation Notes:

- Wall backing is required if wall mounted
- May be part of a diagnostic set in certain configurations

This information is provided for planning purposes only and is not to be relied upon. Final installation specifications are dependent upon selected supplier's shop drawings.



Item Description
Tourniquet

Equipment Number
14-072

Potential Manufacturer ----- Zimmer ----- Stryker -----	Model Number ----- ATS ----- SmartPump -----
--	---

Further Description:

- Dual-port and dual-cuff automatic tourniquet system used in critical care environment

Specifications:

Dimensions:
On IV pole: W x D x H: 590 x590 x 1800 mm

Electrical Requirements:
120 V AC, 60 Hz, 5 A



This information is provided for planning purposes only and is not to be relied upon. Final installation specifications are dependent upon selected supplier's shop drawings.

stryker®

COMMITTED
TO YOUR SUCCESS.



Stryker SmartPump

Tourniquet System

Another Smart Solution From Stryker

BLOOD MANAGEMENT



Another Smart Solution From Stryker SmartPump® Tourniquet System

Stryker SmartPump® tourniquet systems are the elite tourniquet systems offering superior performance and intuitive cuff controls.

Intuitive Cuff Controls simplify training and minimize the impact of staff turnover. Time or pressure settings may be changed quickly and safely using the unit's "Set /Save" logic. New settings are activated only when saved. All controls deliver audible alerts should a user attempt an inappropriate control sequence.

Real-time Cuff Management is supported by logical, audible, and visual alarms. Pressure variances are typically detected and corrected to the target pressure with real-time feedback.

Rapid Inflation

Internal bladder design speeds cuff inflation rate.

Ease-of-Use

Simple, logical cuff controls minimize staff training.

Reliability

Internal battery feature provides safety backup for up to five hours.



SmartPump Dual Channel

The SmartPump Dual Channel tourniquet system delivers complete operating room utility. It supports single cuff, Bier Block and bi-lateral procedures or simultaneous surgeries of both upper and lower extremity. The Dual Channel continuously monitors, controls and displays real-time cuff activities. Each cuff's pressure and inflation time settings are independently managed.

SmartPump® Tourniquet System

Complete Selection of Cuffs



Colour Cuff® Reusable Tourniquets

Designed for durability, strength, and extended use.

Colour Cuff reusable tourniquets feature a BarbLock™ retainer which enhances connector security by locking the connector to the hose.

Heavy duty urethane tubing is combined with stainless steel connectors for extended use.

Colour Cuff is available in single or dual port configurations with stainless steel Quick Connect or Luer Lock connectors.



Colour Cuff® Sterile Disposable Tourniquets

Eliminate the risk of cuff-borne cross contamination with sterile, disposable, Colour Cuff cylindrical tourniquets.

Colour Cuff combines its low profile, roll resistance and contour compliance to deliver uniform tourniquet pressure. Colour Cuff is available in single or dual port configurations with Quick Connect or Luer Lock connections.

Colour Cuff's patented bladder system offers

- Improved stability, roll resistance, and contour compliance, delivering uniform tourniquet pressure
- Low profile, stretch resistant bladder
- Reinforced straps provide easy cuff positioning and security
- Cuff ties provide a final level of alignment and safety
- Colour coded cuffs that provide easy size identification, increased accuracy, and a simplified inventory
- Flexible edges for improved comfort

To order the Reusable Colour Cuff, Disposable Colour Cuff, or additional Stryker tourniquet supplies, contact your Stryker sales representative or call toll free: Strkyer Australia: 1800 803 601 Stryker New Zealand: 0800 787 9287

SmartPump® Tourniquet System Ordering Information

Dual Channel SmartPump

5920-011-000	Dual Channel Pump includes 10' Power Cord, User Guide, Quick Reference Guide
5920-013-000	Rolling Stand includes Stand, Support Pole, Basket for Tourniquet Cuffs

Product specifications are subject to change without notice. Warranty Statement & Technical Product Specifications available upon request.

COMMITTED TO YOUR SUCCESS.

stryker®

Joint Replacements

Trauma, Extremities & Deformities

Craniomaxillofacial

Spine

Biologics

Surgical Products

Neuro & ENT

Interventional Spine

Navigation

Endoscopy

Communications

Imaging

Patient Care & Handling Equipment

EMS Equipment



OUR PRODUCTS

A surgeon must always rely on his or her own professional clinical judgment when deciding whether to use a particular product when treating a particular patient. Stryker does not dispense medical advice and recommends that surgeons be trained in the use of any particular product before using it in surgery.

The information presented is intended to demonstrate the breadth of Stryker product offerings. A surgeon must always refer to the package insert, product label and/or instructions for use before using any Stryker product. Products may not be available in all markets because

product availability is subject to the regulatory and/or medical practices in individual markets. Please contact your Stryker representative if you have questions about the availability of Stryker products in your area.

Products referenced with ™ designation are trademarks of Stryker. Products referenced with ® designated are registered trademarks of Stryker. Copyright © 2014 Stryker. Printed in Australia.

Literature Number: 9100-001-830 SSP Rev. None

Stryker Australia

8 Herbert Street, St Leonards NSW 2065
T: 61 2 9467 1000 F: 61 2 9467 1010

Stryker New Zealand

515 Mt Wellington Highway, Mt Wellington Auckland
T: 64 9 573 1890 F: 64 9 573 1891

For more information contact your local Stryker Sales Representative

www.stryker.com.au



Equipment Datasheet

Item Description
Stress Testing System w/Treadmill

Equipment Number
14-141

Manufacturer ----- GE ----- -----	Model Number ----- T2100/ CASE ----- -----
--	---

Further Description:

- **Performance specifications**
- **Maximum rated load 450 lbs. (204 kg)**
- **Belt speed range 0 to 13.5 mph at 220 VAC/60 Hz continuously variable; 0 mph start-up**
- **Driver motor 3.0 hp**
- **Elevation motor 1/10th hp**
- **Elevation range 0 to 25% grade, continuously variable**
- **Maximum leakage current 100µA, chassis to ground**

Interface

- **CASE® Cardiac Assessment System for Exercise**
- **CASE 8000 exercise testing system**
- **CardioSoft™ multifunction PC-based diagnostic software**
- **Also interfaces with many legacy products**



Specifications:

Physical specifications

- Weight 400 lbs. (181.4 kg)
- Walking area 18 x 60 in. (45.7 x 152.4 cm)
- Floor space required 29 x 77 in. (73.7 x 195.6 cm)
- Walking surface height 5.5 in. (14.0 cm)
- Handrail height Front – 40 in. (101.6 cm)
- above walking surface Side – Maximum 35 in. (88.9 cm) descending at a 5° angle to 32 in. (81.3 cm)

Environmental specifications

- Power requirements 200 to 240 VAC, 50/60 Hz, single-phase,
- 20 amperes, NEMA 6-20 R wall socket
- (dedicated circuit recommended)

Operating conditions

- Ambient temperature 50° F to 95° F (10° C to 40° C)
- Relative humidity 15% to 90%

This information is provided for planning purposes only and is not to be relied upon. Final installation specifications are dependent upon selected supplier's shop drawings.

Item Description: Exercise Treadmill	Equipment Number: 14-141.1
--	--------------------------------------

Potential Manufacturer ----- Fitness Depot ----- Best Buy -----	Model Number ----- Body Break ----- Nordic Track -----
--	---

Further Description:

- A general exercise treadmill with adjustable speeds and incline, with variable optional accessories based of the clinical needs



Specifications:

Dimensions and weight:
W x D x H: 1010 x 1980 x 1550 mm
Weight: 140 kg

Electrical Requirements:
120V AC, 60 Hz, 15A

Design and Installation Notes:

- Floor mounted power box is by the front side of the treadmill

This information is provided for planning purposes only and is not to be relied upon. Final installation specifications are dependent upon selected supplier's shop drawings.



Equipment Datasheet

Item Description Washer, Ultrasonic	Equipment Number 14-263
--	----------------------------

Manufacturer ----- Getinge -----	Model Number ----- ----- -----
---	---

ECRI definition:

Surgical instrument washers designed for automatic removal of dirt, stains, and/or biological debris (i.e., washing) from labware (e.g., glass and plastic beakers, test tubes), surgical instruments, and/or other critical devices using ultrasonic energy. The process is performed by delivering ultrasonic waves to a tank filled with a warm cleaning solution (e.g., detergents formulated for ultrasonic cleansing). These systems typically include a radiofrequency generator (frequencies from 25 to 40 kHz are typical), ultrasonic transducers, a heating unit, and a stainless steel tank with baskets and/or trays. Cleaning is performed by the scrubbing action of the ultrasonic vibration and also by the implosion of bubbles (i.e., cavitation effect). Surgical instrument ultrasonic washers may include two or three tanks to perform automatic cycles for washing, rinsing, and drying; they may also include heating capabilities. This equipment may provide some level of disinfection by killing and/or inactivating several microorganism species; it is commonly used after general cleaning and before thermal or chemical disinfection. Both stand-alone and tabletop units are available for use in central supplies departments of healthcare facilities

Further Description:

ULTRASONICS

- Transducer Type: Piezoelectric
- Quantity: 24
- Tank Bonding: Vacuum Brazed
- Generator Output: 1,000 Watts
- Frequency: 40 kHz
- Stainless Steel Construction
- Automated Controls
- Elevated back splash panel
- Marine edge top
- Recessed tank lid
- Automatic load tray elevator
- Automatic drain
-



Specification:

GENERAL SPEC

- Overall Cabinet: 33-1/2" L x 27-1/2" W x 41" H
- (851 x 686 x 1042 mm)
- Working Height: 36" (915 mm)
- Dry Weight: 335 Pounds (152 kg)
- Operating Weight: 514 Pounds (233 kg)

ELECTRICAL SUPPLY OPTIONS

- 120 Volt, 60 Hz, 1-Ph, 13.4 Full Load Amps

MECHANICAL

- Cold Water: 1/2" IPS 50-60 PSIG Demand 1 GPM cons: .4 Gal / Cycle
- Hot Water: 1/2" IPS 40-50 PSIG Demand 2 GPM cons: 16 Gal / Cycle
- Drain 1-1/2" CPVC STUB-OUT deman 13 GPM

Consideration:

- Floor mounted equipment
- Require water and drain
- Pressure regulator may be needed fuse disconnect 30A 250V
- May need sink closed by

This information is provided for planning purposes only and is not to be relied upon. Final installation specifications are dependent upon selected supplier's shop drawings.



WEIGHTS	
NET	335 LBS.
OPERATING	514 LBS.
SHIP	380 LBS.

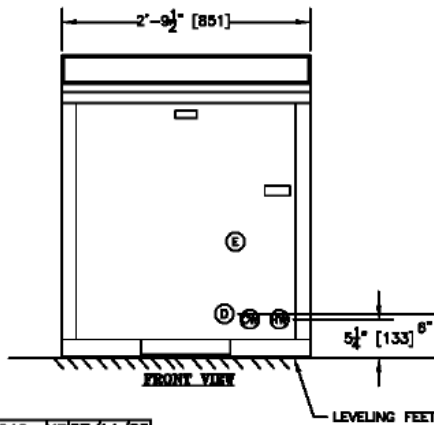
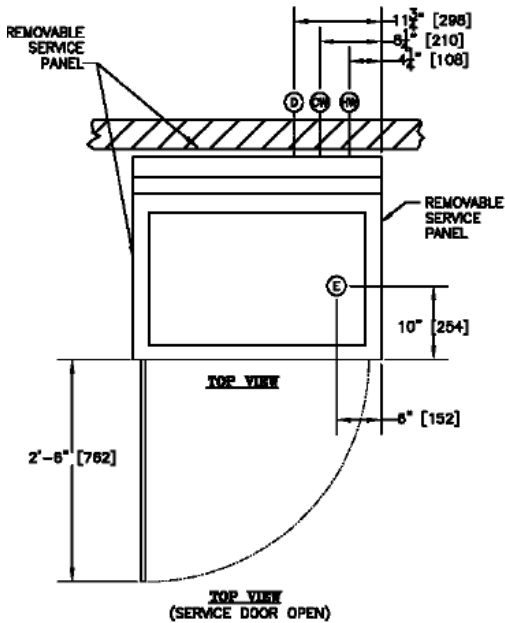

NOTICE: WORK BY OTHERS
SAFE AND EFFICIENT OPERATION OF THIS PRODUCT IS DEPENDENT UPON THE OWNER/USER PROVIDING THE SERVICES SPECIFIED HEREIN AS WELL AS ANY OTHER NORMALLY ACCEPTED ELECTRICAL, MECHANICAL OR PLUMBING INTERFACE BETWEEN USER'S SUPPLY AND THIS PRODUCT. GETINGE WILL NOT ASSUME RESPONSIBILITY FOR PROBLEMS THAT RESULT FROM NON-COMPLIANCE WITH THE ABOVE CONDITIONS. THE FOLLOWING CONDITIONS AND SERVICES ARE REQUIRED FOR GETINGE EQUIPMENT AND ARE TO BE PROVIDED BY OTHERS. IT SHALL BE THE CUSTOMER'S RESPONSIBILITY TO COMPLETE ALL ELECTRICAL CONNECTIONS USING PROPERLY SIZED WIRING IN ACCORDANCE WITH THE NATIONAL ELECTRICAL CODE AND ALL APPLICABLE LOCAL CODES. SEE THE INSTALLATION MANUAL FOR SPECIFIC INSTRUCTIONS.

NOTES:

- 1) IT SHALL BE THE CUSTOMERS RESPONSIBILITY TO INSURE BY USE OF PRESSURE REGULATORS OR OTHER MEANS THAT MAXIMUM SPECIFIED PRESSURES ARE NOT EXCEEDED. DYNAMIC PRESSURE IS MEASURED DURING FLOW CONDITIONS. STATIC PRESSURE IS MEASURED DURING SHUT-OFF CONDITIONS. STATIC PRESSURE SHALL NOT EXCEED 100 PSIG FOR ANY SERVICE CONDITION AND MUST BE MEASURED AT POINT OF CONNECTION TO WASHER.
- 2) IT SHALL BE THE CUSTOMERS RESPONSIBILITY TO ELIMINATE WATER HAMMER CONDITIONS SHOULD THEY OCCUR IN THE SERVICE PIPING.
- 3) IT SHALL BE THE CUSTOMERS RESPONSIBILITY TO PROVIDE A PROPERLY SIZED AND LOCATED DRAINAGE SYSTEM IN ACCORDANCE WITH THE NATIONAL PLUMBING CODE.
- 4) IT SHALL BE THE CUSTOMERS RESPONSIBILITY TO ENSURE THAT WATER SUPPLIES ARE PROPERLY PROTECTED FOR INTERNAL CROSS CONNECTION CONTROL IN ACCORDANCE WITH LOCAL BUILDING AND PLUMBING REQUIREMENTS.
- 5) IT SHALL BE THE CUSTOMERS RESPONSIBILITY TO COMPLETE ALL ELECTRICAL CONNECTIONS USING PROPERLY SIZED WIRING IN ACCORDANCE WITH THE NATIONAL ELECTRICAL CODE. ELECTRICAL SERVICE WIRE TO BE MINIMUM RATED @ 300 V, 85°C, 14AWG, 1W-1, 3 CONDUCTOR, UL RECOGNIZED.
- 6) IT SHALL BE THE CUSTOMERS RESPONSIBILITY TO PROVIDE A FUSED DISCONNECT SWITCH, RATED 30 AMPS, 250 VOLTS WITH 3MM CONTACT SEPARATION, AND ALL ELECTRICAL SUPPLY LINES AT THE WASHER LOCATION.
- 7) ALL DIMENSIONS GIVEN ARE FROM FINISHED SURFACES.
- 8) ALL DIMENSIONS ARE FEET/INCHES (MILLIMETERS).
- 9) DRAWING NOT TO SCALE

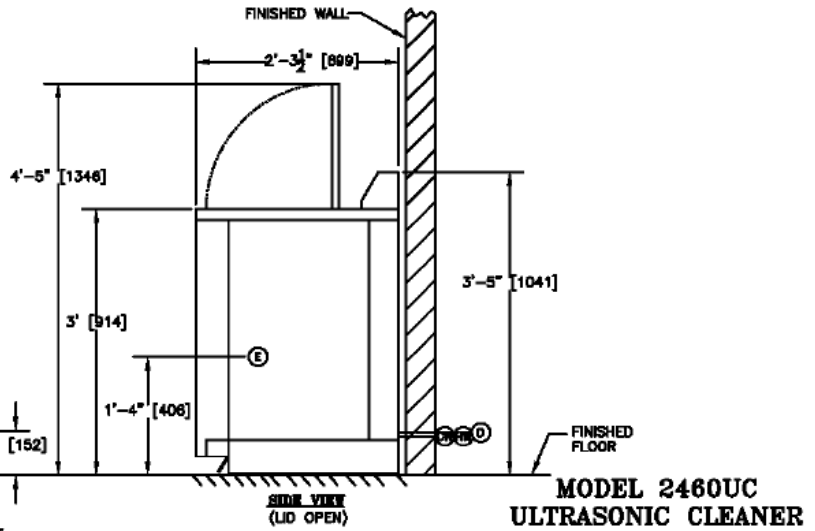

This information is provided for planning purposes only and is not to be relied upon. Final installation specifications are dependent upon selected supplier's shop drawings.



fraserhealth

Better health.
Best in health care.

Equipment Datasheet

Item Description:
Ventilator, Intensive Care, Neonatal/Pediatric

Equipment Number:
14-361

Potential Manufacturer

Heinen Lowenstein

Draeger

Model Number

Leoni plus

Babylog Plus

Further Description:

- A ventilator with sensitive synchronization with gentle but precise support for spontaneous breathing reduces the work of breathing and makes the ventilation process much more comfortable for patients.



Specifications:

Dimensions and weight:

Ventilator (with the cart):
W x D x H: 590 x 610 x 1400 mm
Weight: 75 kg

Electrical Requirements:

115 V AC, 60 Hz

Data Requirements:

1 data port

Plumbing Requirements:

Medical gas and Oxygen are required

Design and Installation Notes:

- UPS power is required

This information is provided for planning purposes only and is not to be relied upon. Final installation specifications are dependent upon selected supplier's shop drawings.



Equipment Datasheet

Item Description Vitrectomy Unit
--

Equipment Number 14-386

Manufacturer	Model Number
Alcon labs	Constellation

Further Description:

The Alcon CONSTELLATION® Vision System establishes the standard of surgical control. Combining ULTRAVIT® High Speed Vitrectomy Probes with Duty Cycle Control, Integrated Pressurized Infusion & IOP Compensation, Advanced Xenon Illumination, and V-LOCITY® Efficiency Components to deliver an exceptional level of performance.



Performance Specification:

Electrical:	115 V 15 AMPS
Data:	
Plumbing:	
Venting:	
Backing:	
Dimensions:	48"H36 W 30 D
Weight:	+100LB

This information is provided for planning purposes only and is not to be relied upon. Final installation specifications are dependent upon selected supplier's shop drawings.



Equipment Datasheet

Item Description Closed Waste Disposal Unit, Multiple Load	Equipment Number 14-421
---	----------------------------

Manufacturer ----- Vernacare ----- Dolphin	Model ----- Vortex ----- Ultima
--	---

Further Description:

- Service access available from the front and top
- Angled front panel allows for side-approach
- Cycle Time: 115 seconds
- Electrical Requirement: 110 volts
- Water Usage: Cold Water only
- Exterior Housing: Stainless Steel
- Foot pedal to open

Specifications:

- Dimensions (Cm): 52 W x 67 D x 136 H (Door open)
- Weight : 75 kg
- Electrical: 120V; 60 Hz; 20A breaker
- Water Mains inlet: Cold water ¾" 7.3 Psi – 145 Psi (0.5 – 10 bar)
- Main Drain: 2" min; also Requires overflow drain (1 ¼")

Installation considerations:

- Space required from the back (min:6") and sides (min:9") and in front for service access
- Drain outlet terminates at a fitting suitable for a 50mm (2") diameter pipe stub with outlet height adjustable between 200mm (7.874") to 239mm (9.409"). P trap supplied and fitted internally.
- Minimum number of long radius/swept bends with maximum run -machine to soil drain- of 2 metres. Fall of 1 in 25 is required (4%)
- The waste must be run separately to the soil stack or drain.
- Water supply in: via 700mm (27.56") long 10mm (0.394") bore flexible water inlet pipe with ¾" GHT female thread supplied.
- Water supply line to the machine is at no point less than 9/16"
- A full-way isolating valve (not supplied), must be fitted to rigid pipe work only before connecting the machine to the mains or storage tank
- Electrical Supply: Connect to a 20 amp circuit with motor switch. disconnect switch must be fitted to the final installation
- The recommended clearances for the Disposal Unit are 6" at the rear and 5" on each side
- Ensure floor area is firm and level
- Requires overflow drain (not to be connected to the main drain without air gap or check valve)
- The machine must be level in both directions.
- Need to be bolted to the floor



Supporting Documents:

[Installation Document](#) [Picture](#)

This information is provided for planning purposes only and is not to be relied upon. Final installation specifications are dependent upon selected supplier's shop drawings.

Item Description
Container, Sharps

Equipment Number
14-423.1

Manufacturer

Model Number

7.6L

- Further Description:**
- Touch less Deposit of Sharps
 - Automatic rotating chamber
 - Sharps can be dropped manually by using the actuating lever.
 - Horizontal drop
 - Puncture resistant molded plastic, translucent red color
 - Containers may be nested for compact storage
 - May be mounted to the wall using optional wall mounting bracket
 - Containers are good for countertop use

Specifications:

Dimensions:

- approx. 11.75"W x 6.75"D x 11"H

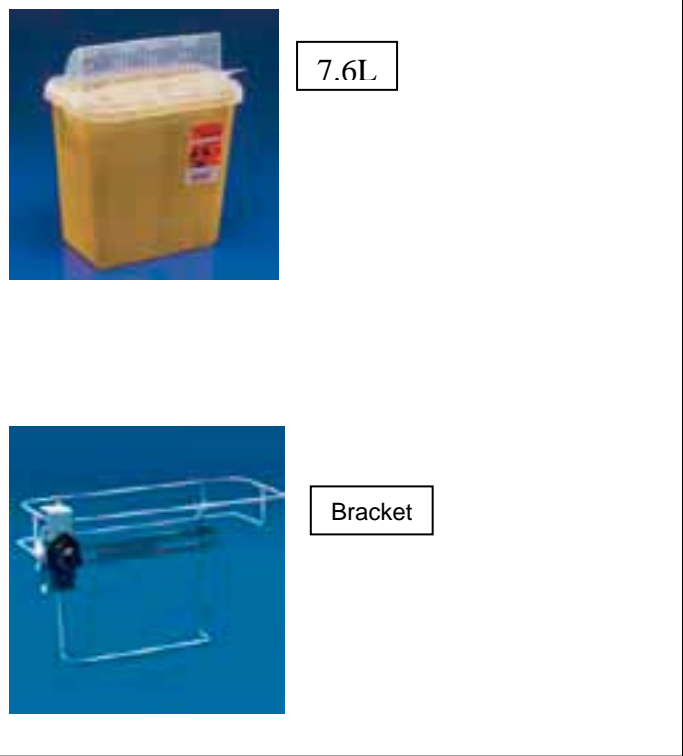

- Installation Considerations:**
- May be wall mounted (using factory designed bracket)
 - May require backing

This information is provided for planning purposes only and is not to be relied upon. Final installation specifications are dependent upon selected supplier's shop drawings.

Item Description Kick Bucket	Equipment Number 14-427
---------------------------------	----------------------------

Potential Manufacturer ----- DREDMED ----- Medline -----	Model Number ----- Pedigo Kick Buckets ----- Stainless Steel Kick Buckets with Stand -----
---	---

Further Description:

- Stainless steel bucket on wheels



Specifications:

Dimensions:

W x D x H: 410 x 410 x 360 mm

Design and Installation Notes:

This information is provided for planning purposes only and is not to be relied upon. Final installation specifications are dependent upon selected supplier's shop drawings.



Item Description:
Lead Shielding, Portable

Equipment Number:
14-490

Potential Manufacturer ----- Z&Z Medical ----- UltraRay -----	Model Number ----- ----- -----
--	---

Further Description:

- lead shield (16 mm thick) panel set in a metal frame to protect the user and the patient from scattered x-ray



Specifications:

Dimensions and weight:

Standing Mobile Shield:
W x D x H: 850 x 410 x 1520 mm
Weight: 60 kg

W x D x H: 1150 x 770 x 2140 mm
Weight: 90 kg

Design and Installation Notes:

This information is provided for planning purposes only and is not to be relied upon. Final installation specifications are dependent upon selected supplier's shop drawings.